

CI_MPS0109

proximity switch, magnetic



Features

- selective switching behaviour due to measuring technique
- stainless steel enclosure for rugged environmental conditions
- pressure resistant due to fully encapsulated sensing surface
- reverse polarity protected
- short-circuit proof

Applications

- hydraulic cylinders
- direct replacment for PM 270321001
PHS1-PS-0100-S09B/PM12-60, DW-LS-703-PM2,DW-LS-703-PM4,
BES 516-300-S355-S4-D

Technical Data

Installation	flush mounting
Switching distance	0.9 mm ¹
Switching frequency	0 ... 1 kHz
Supply voltage	7 ... 30 VDC
Output function	OC, PNP, NO
Output current	max. 200 mA
Operating temperature	-40 ... 110°C
Operating pressure	max. 750 bar
Vibration resistance	40 g
Shock resistance	100 g
Protection class	IP68 ²

- 1) when using ferromagnetic steel, e.g. ST37 or CK45, marks
2) actual protection class depends on mating receptacle

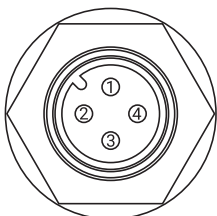
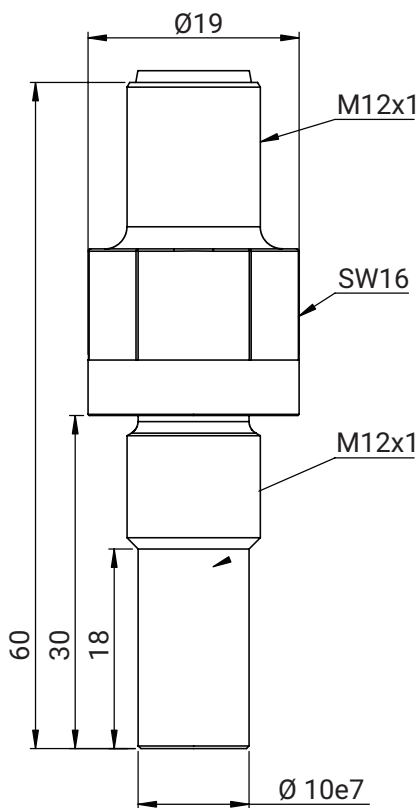

Pinout M12 Plug

Pin 1	Supply voltage
Pin 2	not connected
Pin 3	Ground
Pin 4	Output

Made in Germany!

Karl-Heinz Guenther
Consult-IMPEX e.K.
Haller Str. 189
74564 Crailsheim
Germany



Mobile.: +49 157 8702 9999
Phone: +49 7951 4691 460

VAT: DE301350199
Steuer Nr.: 57258/03915
Amtsgericht Ulm, HRA 724763
EORI: DE899069944611164

Email: kh@consult-impex.com
Homepage: www.consult-impex.com